

CAPIT JOIST SEAL – INSTALLATION INSTRUCTIONS

1. Lay the joists

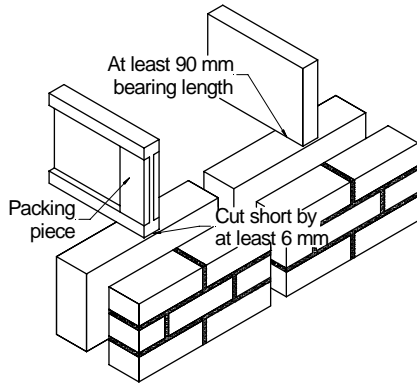

Lay the joists out in the traditional manner on the supporting masonry at the specified pitch ensuring that:

- there is a minimum bearing length of 90 mm on the inner leaf of the wall and
- the joist stops short of the outer face of the inner leaf by at least 6 mm ($\frac{1}{4}$ ")
- if using an I-beam joist, the voids to each side of the joist web are filled for at least 70 mm with plywood packing pieces or a proprietary end fitting as supplied by the joist manufacturer.

2a. Fit the seals: joist height up to 225 mm

For joist heights up to 225 mm use a basic CAPIT joist cap without an extender.

Place the joist cap over the end of the joist so that the rear of the joist cap touches the end of the joist and so that the bottom of the joist cap rests on the blockwork.

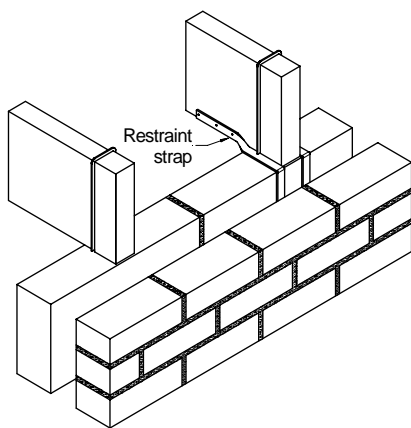

2b. Fit the seals and extenders: joist height from 225 to 410 mm

For joist heights above 225 mm and up to 410 mm, use a CAPIT joist seal with a CAPIT extender.

With the cap and extender fully telescoped together,

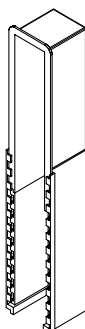

place them over the end of the joist so that the rear of the joist cap touches the end of the joist and so that the top of the joist cap rests on the top of the joist.

Then slide the extender down so that the bottom of the extender rests on the blockwork.

Ensure that the side flanges of the joist cap are properly located in the side channels of the extender.

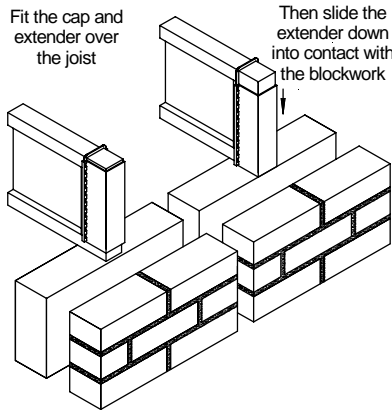

3. Restraint straps

If specified or required, fit twist-and-bend restraint straps ensuring that the straps pass through the notches at the bottoms of the flanges of the joist cap or extender and do not lift the joist cap or extender off the masonry below.

4. Prepare filling between joists

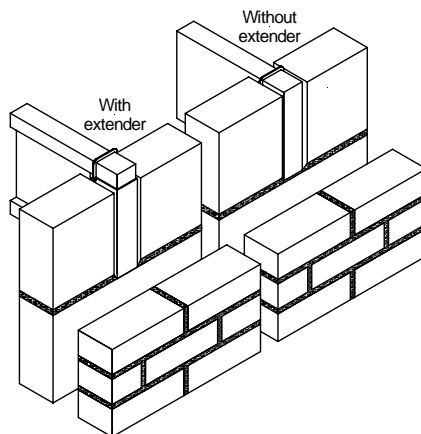

Cut blocks or bricks square to fit between the joist caps with a gap for a mortar joint between the blocks and joists and joist caps.

For blockwork walls, the blocks should be cut with a saw and the use of brick infills should be avoided.

For brick walls, cut bricks should be turned with uncut edges against the joist cap, with a gap for a mortar joint.

5. Mortar-in the joists

Fill the gaps between the wall and joist cap and joist with mortar, and tool-in well to the sides of the joist and the joist cap.

6. Complete the wall

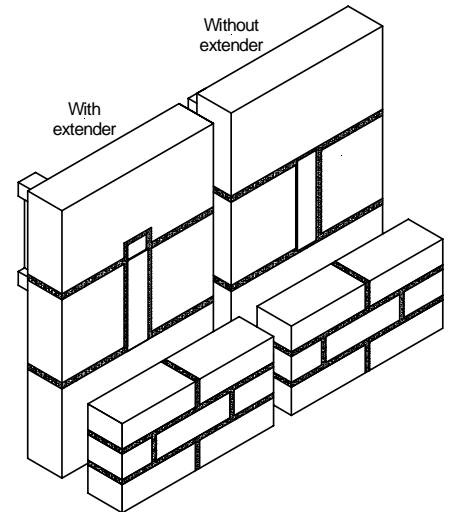

Complete the wall following normal practice, and add surrounding detail in the conventional manner.

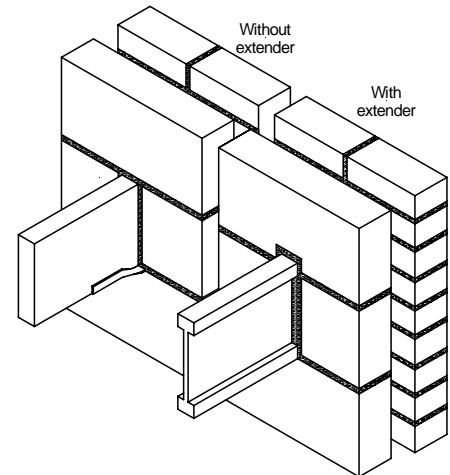

7. Multiple joists

Capit joist seals are available for joist widths up to 100 mm. A single large joist cap can be used to cover the ends of two or more joists totalling up to 100 mm in width. Alternatively, fit a separate cap to each joist after first removing the adjacent vertical flanges.

Capit Building Products Ltd

Avro Way, Bowerhill Industrial Estate,
Melksham, Wiltshire, SN12 6TP
Tel: 01225 791124

www.capit-building-products.co.uk

tech@capit-building-products.co.uk

The basic CAPIT joist seal is BBA approved.



Drawing No. CJSIIv2
Date: 22/07/2008

© 2008 Capit Building Products Ltd
Patented: GB2394234 GB2420799 GB2426987